

5. REMOVE INSIDE TRIM

Use lever catch tool to depress lever catch visible under hole of inside lever shank and slide off inside lever, rose liner and mounting plate.

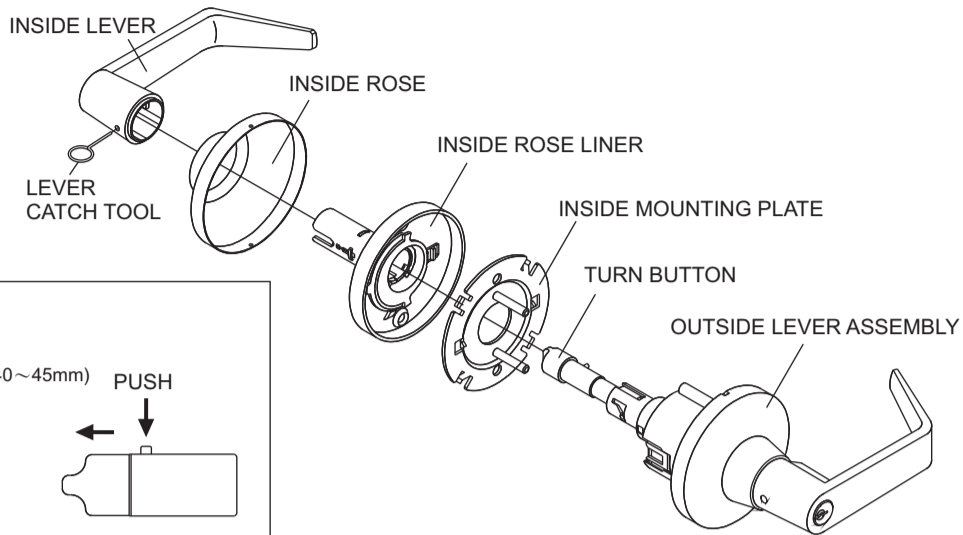

ADJUST DOOR THICKNESS

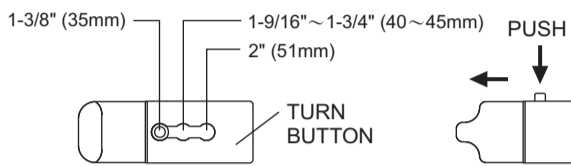

6. ADJUST DOOR THICKNESS

- Remove outside mounting plate toward cylindrical case.
- Put the catch tool into the allocated position of outside mounting plate as the illustrating bellow.
- Rotate outside mounting plate to required door thickness by using a catch tool.

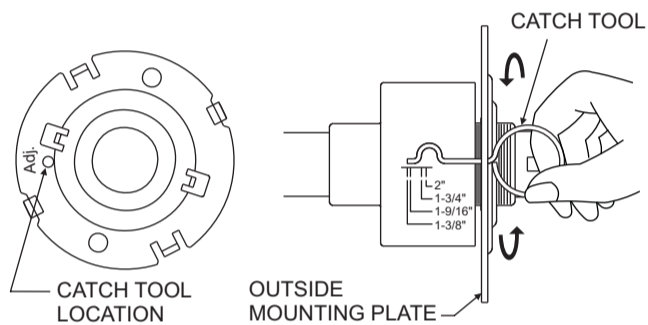

7. INSTALL OUTSIDE LEVER ASSEMBLY

Install outside lever assembly on the door. Make sure tail of latch is engaging with retractor correctly as illustrated.

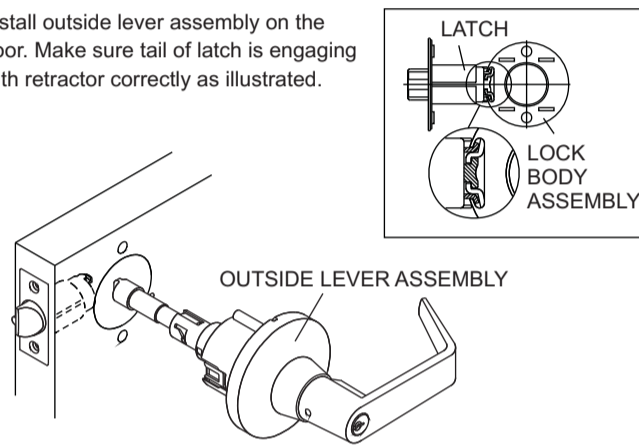

8. INSTALL INSIDE MOUNTING PLATE AND ROSE LINER

- Install inside mounting plate to lock body.

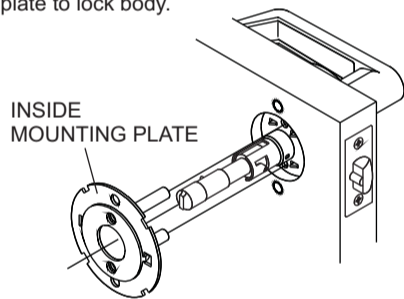

- Press inside rose liner onto mounting plate and tighten mounting screws securely.

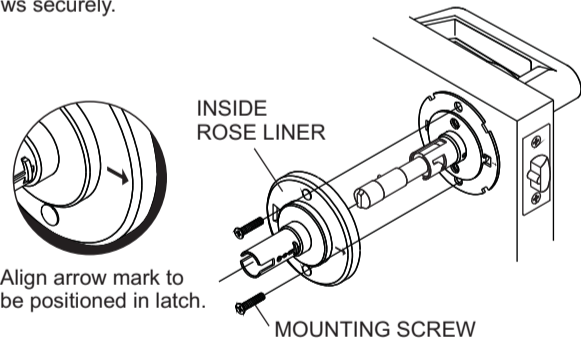

9. INSTALL INSIDE ROSE AND LEVER

- Be sure to fit rose in recess of rose liner.

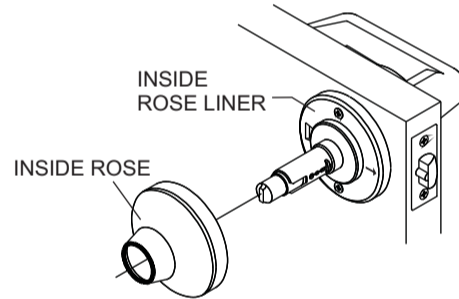

- Depress lever catch with tool provided. Push inside lever on completely until catch engages in lever. Confirm lever is secured.

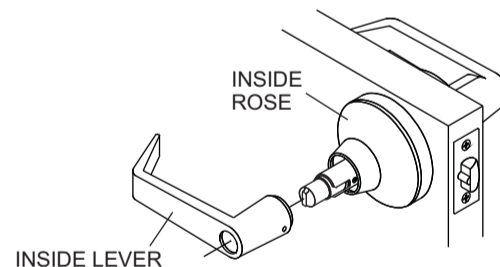

TEMPLATE

NOTE
DO NOT MAKE THE HOLES FOR LOCKS IF REMOVING OUTSIDE SECURING STUDS (THRU-BOLT)

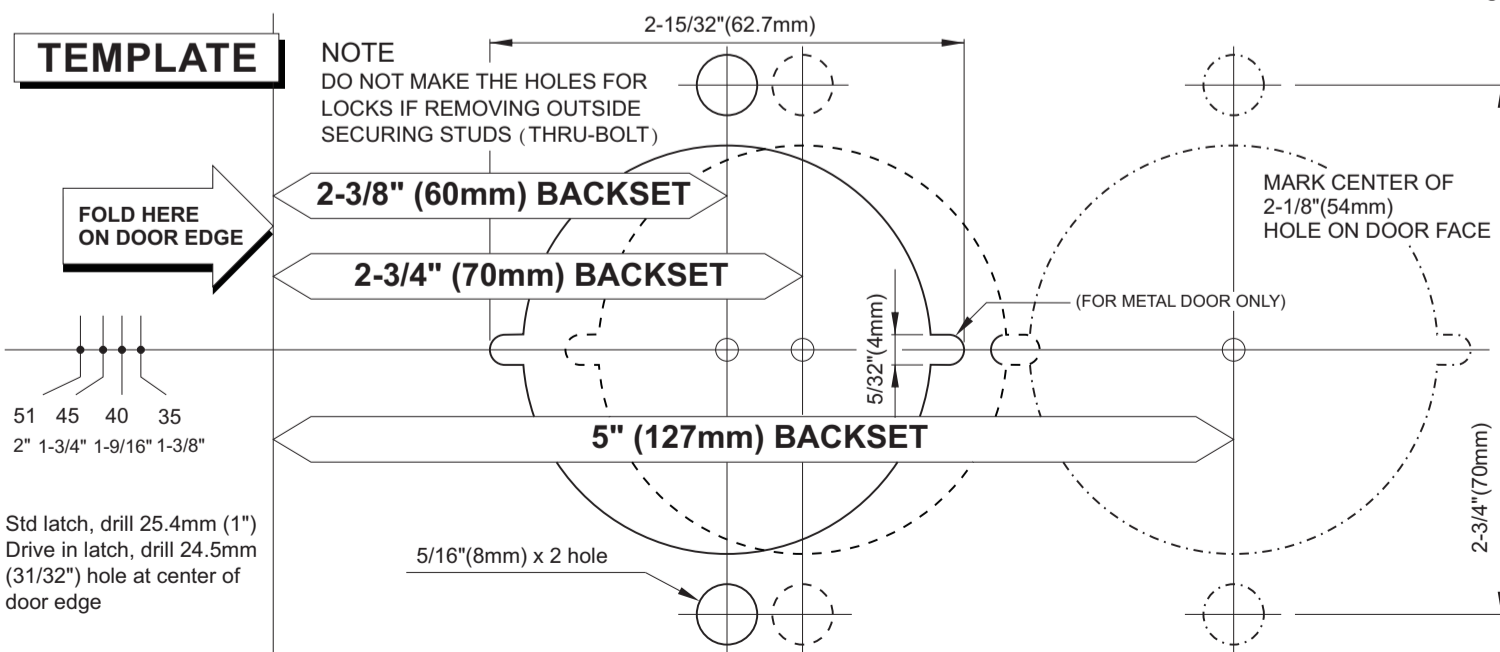

Std latch, drill 25.4mm (1")
Drive in latch, drill 24.5mm (31/32") hole at center of door edge